

DVC6 household AC contactor

Product Overview

The DVC6 series household AC contactors are designed for circuits operating at 50Hz AC, 250V/400V voltage, and currents up to 63A. These devices control household appliances with low inductance, such as microwave ovens and rice cookers, as well as motorized equipment like air conditioners, washing machines, and refrigerators. With their safety, reliability, long service life, and quiet operation, they are widely used in critical facilities including hospitals and hotels.

This product complies with IEC61095

Selection Guide

product name	rated current	number of poles	Main contact type		Voltage type
DVC6	16	2	20		N
	16:16A	2:2P 4:4P	20:2NO	40:4NO	N:220V-240V L:24V
	20:20A		20:2NO	40:4NO	
	25:25A		02:2NC	04:4NC	
	40:40A		02:2NC	04:4NC	
	63:63A		11:1NO,1NC		
	22:2NO,2NC				
		10:1NO			
		31:3NO,1NC			
		10:1NO			
		31:3NO,1NC			
		01:1NC	30:3NO		
		01:1NC	30:3NO		
		03:3NC			

technical parameter

Contactor type	2P-1	4P-1	2P-2	4P-2	2P-2	4P-2	2P-4	4P-4	2P-6	4P-6
		6	6	0	0	5	5	0	0	3
Ui (V)	500									
Ith(A)	25					63				
Le(A)	AC-7a	16	20	25	40	63				
	AC-7b	6	7	8.5	15	20				
EL	Ct	100000								
ROF/	AC-7	360								

H	a										
	AC-7 b	360		180		180		120		90	
MCS	AC-7 a	1.05I _e									
	AC-7 b	6I _e									
I _{cw} (A)		8I _e (AC-7b)/10S									
U _s (V)		AC24V AC220-240V									
UC	PUV	85%-110%U _s									
	DR	20%-75%U _s									
P _c	StC	9.2	34	9.2	34	9.2	34	34	53	34	53
	Hsv	2.7	4.6	2.7	4.6	2.7	4.6	4.6	6.5	4.6	6.5
Pw-coil(w)		1.2	1.6	1.2	1.6	1.2	1.6	1.6	2.1	1.6	2.1

U_i: rated insulation voltage; I_{th}: rated heating current; I_e: rated operating current; EL: electrical life; ROF/H: rated operating frequency;

MCS: Turn-on and turn-off capability; ICW: Short-time current tolerance; US: Coil control voltage; UC: Engage and release; PC: Coil power;

PW-COIL: Power in operation.

DVC6 Overall Dimensions and Mounting Dimensions

16-25A Overall Dimensions and Mounting Dimensions

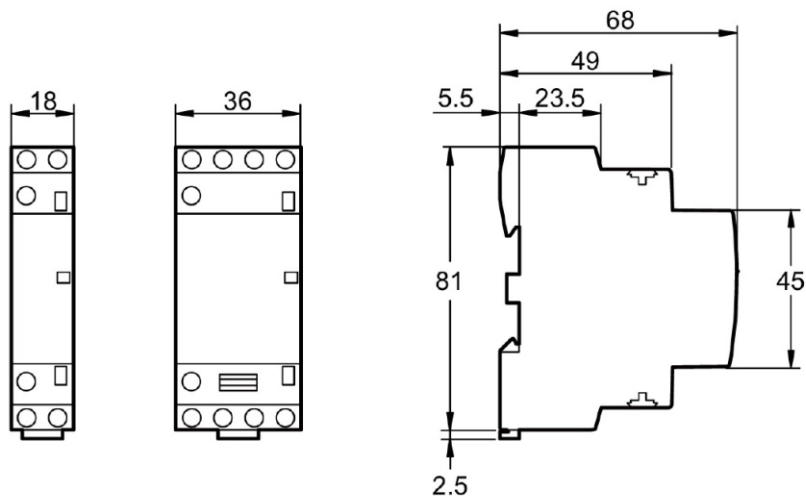

DVC6-40-63A Overall Dimensions and Mounting Dimensions

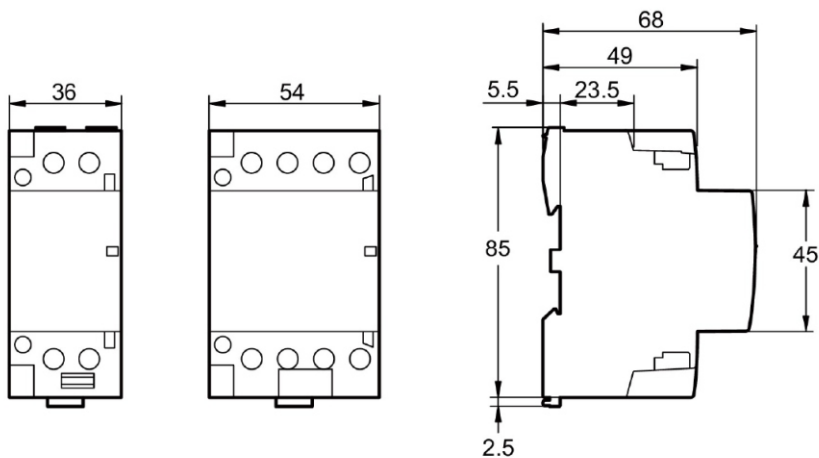

Work instruction: The contactor's front has a red signal indicator, indicating the coil is energized.